

SERVICE SCHEDULE

* Service only when machine is equipped with this item.

■ Service at first 50 hours, then as scheduled.

▲ Service at first 100 hours, then as scheduled.

EVERY 8-10 HOURS

- * Check engine coolant level. Add premixed coolant as needed (water cooled engines only).
- Check engine oil level.
- Check hydraulic fluid level.
- Check and adjust track tension as needed.
- Check indicator lights for correct operation.
- Check canopy or *cab condition and mounting hardware.
- Check seat belt condition and mounting hardware.
- Check for damaged signs (decals) - Replace any signs (decals) that are damaged or worn.
- Grease all machinery pivot points. (See illustrations)
- Drain water and sediment from fuel tank and fuel filter.
- Check control console lockout for proper operation.
- Check for leaks and and/or tightness of pipes, hoses, control unit, hydraulic pumps, cylinders, etc.

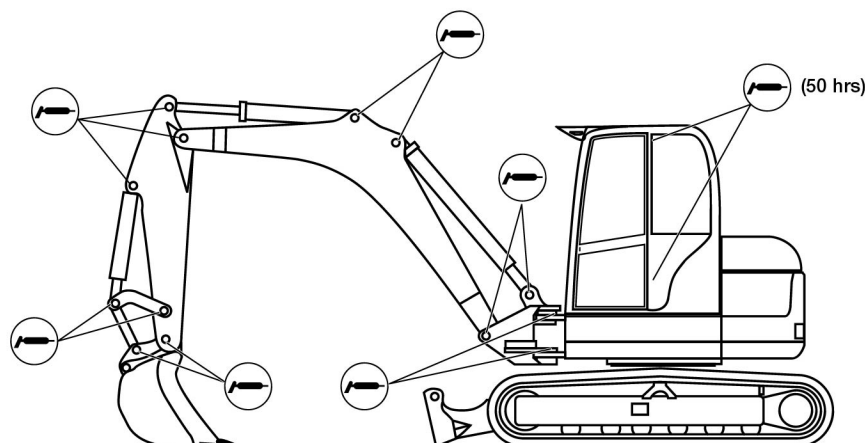

EVERY 50 HOURS

- Grease swing pinion, swing circle and door hinges.
- Check battery, cables, connections and electrolyte level. Add distilled water as needed.

EVERY 100 HOURS

- Check condition of belts and adjust as needed.

EVERY 250 HOURS

- Check oil level in both final drive cases.
- ▲ Clean hydraulic oil cooler, *engine oil cooler, *radiator, *A/C condenser and clean / replace cab ventilation filter.

EVERY 500 HOURS

- ▲ Replace hydraulic filter.
- Check alternator and starter connections.
- Replace diesel fuel filter and prefilter.
- Check air intake.
- ▲ Replace engine oil and filter.

EVERY 1000 HOURS OR EVERY 6 MONTHS

- Check and adjust engine valve clearance.
- ▲ Replace oil in both final drive cases.
- * Drain and flush cooling system - Replace coolant (water cooled engines only).
- Replace hydraulic fluid and filter(s) - Clean reservoir.

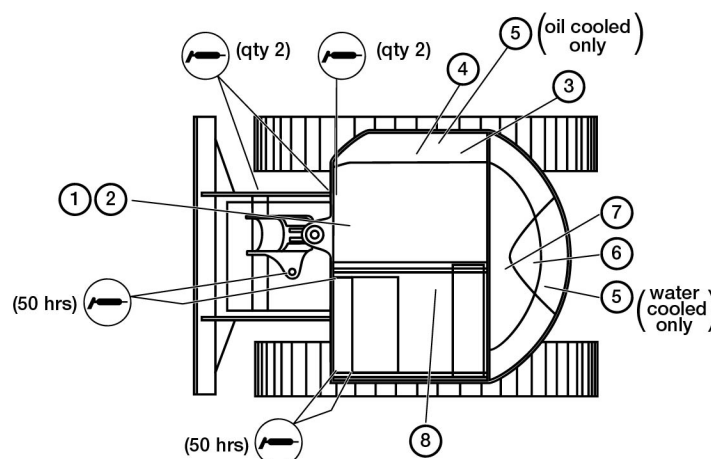

IMPORTANT

THIS MACHINE IS FACTORY EQUIPPED WITH A U.S.D.A. FORESTRY SERVICE APPROVED SPARK ARRESTOR EXHAUST SYSTEM.

THE SPARK ARRESTOR MUFFLER, IF EQUIPPED, MUST BE CLEANED TO KEEP IT IN WORKING CONDITION. THE SPARK ARRESTOR MUFFLER MUST BE SERVICED BY DUMPING THE SPARK CHAMBER EVERY 100 HOURS OF OPERATION.

ON SOME MODELS, THE TURBOCHARGER FUNCTIONS AS THE SPARK ARRESTOR AND MUST OPERATE CORRECTLY FOR PROPER SPARK ARRESTOR FUNCTION.

[IF THIS MACHINE IS OPERATED ON FLAMMABLE FOREST, BRUSH OR GRASS COVERED LAND, IT MUST BE EQUIPPED WITH A SPARK ARRESTOR ATTACHED TO THE EXHAUST SYSTEM AND MAINTAINED IN WORKING ORDER. FAILURE TO DO SO WILL BE IN VIOLATION OF CALIFORNIA STATE LAW, SECTION 4442. PRC.]

REFER TO LOCAL LAWS AND REGULATIONS FOR SPARK ARRESTOR REQUIREMENTS.

SEE THE OPERATION AND MAINTENANCE MANUAL FOR MORE INSTRUCTIONS.

FILTER CHART

		DEUTZ	
		(water-cooled)	(oil-cooled)
1.	PRIMARY AIR FILTER	5501660912	5501660912
2.	SECONDARY AIR FILTER	5501660914	5501660914
3.	ENGINE OIL FILTER	5411316400	5411642211
4.	FUEL FILTER	5411656567	5411656301
5.	FUEL PRE FILTER	5445100004	5411657863
6.	HYDRAULIC VENTILATION FILTER	5501655650	5501655650
7.	HYDRAULIC INSERT FILTER	5380658088	5368632568
8.	CAB VENTILATION FILTER	5501661034	5501661034

• See illustrations above for filter locations.